

# Quick Start Guide

Liquid Station 1

---

Learn more at [linksquare.io/help](https://linksquare.io/help)



LinkSquare

# About Liquid Station 1

Liquid Station 1 is intended for use with LinkSquare 1.  
For more information about Linksquare 1, please visit [linksquare.io](https://linksquare.io).



## ***SAFETY INSTRUCTIONS***

Before using your Liquid Station 1, please read carefully all the safety precautions in the Product and Safety Instructions.







## ***CUSTOMER SUPPORT***

Need help? Want more information?  
Contact us at [linksquare.io/contact](https://linksquare.io/contact)



## ***CONNECT WITH US***

-  [fb.com/linksquareIR](https://fb.com/linksquareIR)
-  [twitter.com/LinkSquareIR](https://twitter.com/LinkSquareIR)
-  [instagram.com/stratio.linksquare.beyonsense](https://instagram.com/stratio.linksquare.beyonsense)
-  [youtube.com/StratioLinkSquareBeyonSense](https://youtube.com/StratioLinkSquareBeyonSense)

# Product Diagram

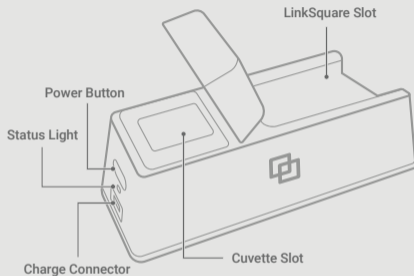

## ***WHAT'S IN THE BOX?***

- 1 Grab-and-go Case
- Liquid Station 1
- 2 Cuvettes
- Quick Start Guide
- Product and Safety Instructions

# Prepare

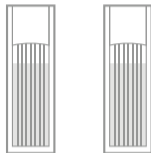
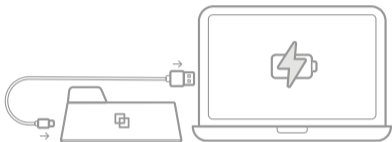

## 1 FULLY CHARGE YOUR LIQUID STATION 1 PRIOR TO USE

The **Status Light** will stop blinking when charging is complete.

## 2 POUR YOUR LIQUID SAMPLE(S) INTO CUVETTE(S)

Pour the liquid for your analysis into the provided cuvette(s) and slide each cuvette into the **Cuvette Slot**.

**CAUTION:** Windows without grooves must face towards the **LinkSquare Slot**.

# Turn On



3

## TURN ON YOUR LIQUID STATION 1

The **Status Light** turns white when the Liquid Station is on.

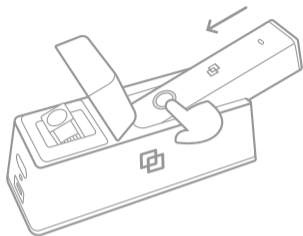

4

## INSERT LINKSQUARE 1 DEVICE

Ensure that the LinkSquare 1 device is on before sliding it into the **LinkSquare Slot**.

# Scan

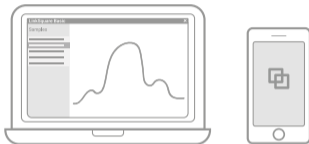

5

## RUN LINKSQUARE APP OR COLLECTOR SOFTWARE

Ensure that the LinkSquare 1 device is connected to LinkSquare app or collector software.

**NOTE:** LinkSquare app is downloadable for free on Android or iOS devices. Collector software can be purchased at [linksquare.io/order](https://linksquare.io/order).

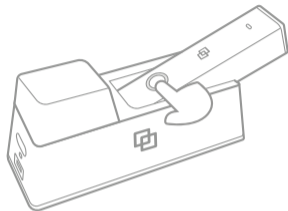

6

## START SCANNING

Press the **LS Button** on your LinkSquare 1 device or click "SCAN" in the app or collector software.

## Like Video Better Than Text?



Learn to use your Liquid Station in a minute  
with this video that we made  
**for you**

---

[bit.ly/LiquidStation](https://bit.ly/LiquidStation)



LinkSquare

[linksquare.io](https://linksquare.io)